

EMERGENCY SHOWER & EYEWASH

64-CSE01



Jaybro

CONSIDER IT DONE.



INSTRUCTION MANUAL





IMPORTANT

PLEASE READ THIS OPERATION MANUAL BEFORE USING THIS PRODUCT. THIS MANUAL CONTAINS IMPORTANT INFORMATION REGARDING SAFETY, OPERATION & MAINTENANCE.

OPERATION

Combination Unit

1. According to the regulations of OSHA 29 CFR 1910.151 (C), install this unit in a place where you can arrive within 10 seconds from the hazardous material-handling workshop.
2. Be located in an area identified with a highly visible sign and the area around the facility is well-lit.
3. Ensure that the hydraulic pressure of the supply water is 210kPa and the water temperature is 16-38°C.
4. Employees who may be exposed to hazardous materials shall be trained in the location and proper use of emergency equipment.
5. The injured individual should proceed to the unit and flush eyes and face for the required 15-minute period.
6. Shower head shall be not less than 2083mm and not more than 2438mm from the surface on which the user stands.
7. Shower shall deliver a minimum of 75.7 L/min of flushing fluid at 210kPa, with the flushing fluid being substantially dispersed throughout the pattern which shall be of a minimum diameter of 508mm when measured at 1524mm above the surface on which the user stands.
8. The shower operating control valve shall remain open without the use of the operator's hands. The valve shall be simple to operate and shall go from closed to fully open in one second or less and not be located more than 1733mm from the surface on which the user stands. The valve shall be corrosion-resistant.
9. Eye wash equipment shall deliver flushing fluid to the eyes simultaneously at a flow rate not less than 11.4L/min at 210kPa. The flushing fluid streams should rise to approximately equal heights and should cover the areas between the interior and exterior lines of the test gauge when lowered not more than 38mm below the fluids peak.
10. The flushing fluid nozzles of eye and eye/face wash units shall be not less than 838mm and no greater than 1143mm from the surface on which the user stands and 153mm from the wall or nearest obstruction.
11. The eye and eye/face wash operating control valve shall remain open without the use of the operator's hands. The valve shall be simple to operate and go from closed to fully open in one second or less. The valve shall be corrosion-resistant.

SAFETY PRECAUTIONS

- This instruction manual describes the general installation method, but please install it according to the local law and the actual situation.
- According to the regulations of OSHA 29 CFR 1910.151(C), install this unit in a place where you can arrive within 10 seconds from the hazardous material handling workshop.
- Safety equipment shall be located on the same level as the hazard and the path of travel shall be free of obstructions.
- Employees who may be exposed to hazardous materials shall be trained in the location and proper use of emergency equipment.
- According to the ANSI Z358.1-2014 standard, ensure that the hydraulic pressure of the supply water is 210kPa, and the water temperature is 16-38°C.
*Water pressure with the eyewash shower running.
(The hydro-static pressure is around 0.2-0.4MPa, but it depends on the operating environment.)
- Make sure that the installed pipe is leak-free and all plumbed emergency equipment shall be connected to a continuous source of flushing fluid supply which may be drinking water, preserved water, preserved buffered saline solution or other medically acceptable solution manufactured and labeled in accordance with applicable government regulations.
- Emergency equipment shall be activated weekly to verify operation. Also, perform an annual periodic inspection. This is an important task mandated by ANSI Z358.1.
- If you have any questions regarding the operation or installation of the product, please contact the store where you purchased the product.
- When installing on a wall, check beforehand whether it can be installed from the weight of this unit and piping and the material of the wall.

DESCRIPTION

A hand and foot operated unit which combines eye/face wash with a deluge shower head. The unit is stainless steel, resisting corrosion and giving solid support for the shower and eyewash. Activators are easy to locate and use. A top of the range unit with quality components throughout.

Soft flow eye wash heads have built-in automatic pressure compensating valves to assure steady flow under varying water supply conditions. Heads have instant lip-open dust covers and built-in filter to protect the users against particles in the water flow which may be damaging to the eyes.

Flowsafe eye/face washes and showers are one of the most competitive on the market, stainless steel pipe will outlast most other brands and is heavy duty, chemical resistant bright yellow ABS bowl to handle the most rugged environment.

Epoxy powder coated Bright Yellow and is easy to see and from kit form is very quick and easy to install, made from 316 grade stainless steel with a 2-year warranty.



INSTALLATION

Combination Unit

- a. Screw the pipe (2) to the pedestal (1), then screw the three-way pipe (4) to the pipe (2).
- b. Screw the three-way connection (6) to the pipe (5).
- c. Screw the elbows (9) to the pipe (7).
- d. Screw the pipe (10) to the valve (11).
- e. Screw the connected pipe and valve (10)(11) to the elbows (9).
- f. Screw the pipe (12) to the valve (11).
- g. Attach the pull rod (8) to the valve (11) with screws and nuts.
- h. Screw the connected parts (5-6) to the three-way pipe (4).
- i. Then screw the connected parts (7-12) to the three-way connection (6).
- j. Screw the shower head (13) to the pipe (12).
- k. Screw the bowl (15) into the quick coupling on the three-way pipe (4).
- l. Screw the horn eye wash head (14) to the bowl (15).
- m. As shown in the figure, attach the open/close plate (3) to the valve with screws and nuts.

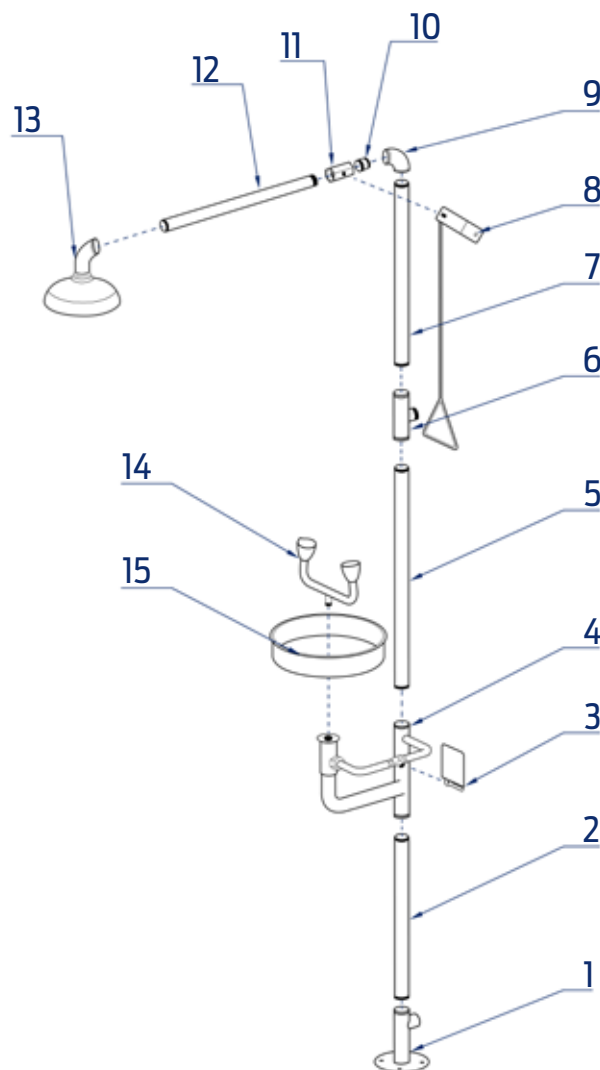

*When you know
it just has to happen...
call Jaybro and
CONSIDER IT DONE®*

SYDNEY

29 Penelope Crescent,
Arndell Park, NSW 2148
02 9678 1491

MELBOURNE

Building A, 1-7 Cyanamid St,
Laverton North, VIC 3026
03 8318 5099

BRISBANE

71 Lavarack Avenue,
Eagle Farm, QLD 4009
07 3056 1701

CANBERRA

3 Daly Street,
Queanbeyan West, NSW 2620
02 9678 1491

NEWCASTLE

100 Glenwood Drive,
Thornton, NSW 2322
02 9678 1491

ADELAIDE

U1/17 Ceafield Road,
Para Hills West, SA 5096

PERTH

5-7 Hopewell St,
Canning Vale, WA 6155



CALL NOW
1300 885 364
jaybro.com.au